

## Main Data Sheet

### Electro Hydraulic Actuator PA-O-Exx-90-EB-SC-(X)

Part turn actuator 90°, limit switch box, single acting, spring to close, X=Explosion proof

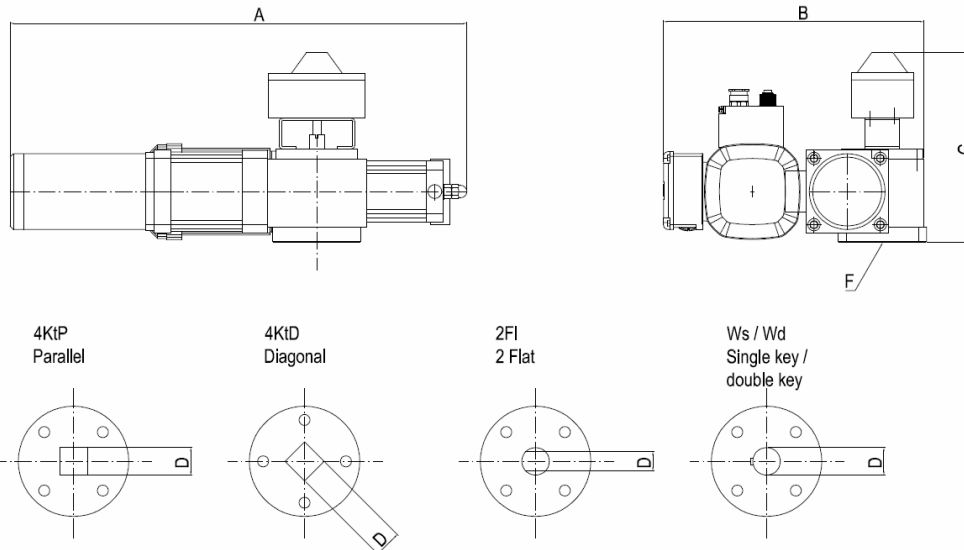

Type	ETC End torque spring Nm	A mm	B mm	C* mm	max. D				F DIN 5211	Weight kg
					4KtP	4KtD	2FI	Ws/Wd		
E20	35	445	305	225	14	14	14	16	F05-F07	25
E30	90	445	325	235	17	17	17	20	F05-F07	35
E35	165	515	360	276	24	24	22	30	F07-F10	40
E40	410	665	380	276	30	30	27	40	F10-F14	70
E55	870	805	440	300	40	40	40	55	F10-F16	105
E60	1200	815	440	300	40	40	40	55	F10-F16	110
E65	1950	1100	550	350	55	55	55	65	F14-F25	170
E70	2400	1125	550	350	55	55	55	65	F14-F25	175
E75	2600	1140	550	350	55	55	55	65	F14-F25	180
E85	4000	1290	655	405	75	75	75	90	F16-F30	225
E110	8000	1650	695	405	75	75	75	90	F16-F30	350

\*with standard limit switch box

Ambient temperature range:	-10°C to 60°C optional -40°C to 80°C (to be confirmed in case of order)
Degree of protection:	IP65
Power supply:	400V50Hz 3Phs; 230V50Hz 1Phs
Solenoid valve, spring close:	24VDC / 230VDC (15W)
Closing speed:	<1sec. up to >60 sec. adjustable with throttle valve depending on actuator size
Hazardous area:	II 2G c k IIC T4 ATEX
SIL:	SIL2 (Architecture 1oo1) other logic on demand
Installation position:	preferred horizontal, others by prior agreement
Manual override	Available